

Use and maintenance instructions

Versus FBT

Fixed luminaire for general use for installation on a wall or on a Ø60mm adapter (via Golf accessory).

TECHNICAL DETAILS: refer to the product label

 The UE declaration of conformity can be downloaded from our website www.marecoluce.it

 Insulation Class II

IP65 Protection degree against dust ingress, solid particles, moisture

 This product must not be disposed as a normal household waste

WARNINGS:

- THE SAFETY OF THIS PRODUCT IS GUARANTEED ONLY WITH THE RESPECT OF THE EXISTING RULES FOR THE ELECTRICAL SYSTEMS, AND WITH THE APPROPRIATE USE OF THESE INSTALLATION INSTRUCTIONS, THEREFORE IT IS NECESSARY TO KEEP THEM.
- THE IMPROPER USE OF THIS PRODUCT IS FORBIDDEN; ANY TAMPERING WITH THE PRODUCT OR MODIFICATION OF THE PRODUCT THAT IS NOT AUTHORIZED BY MARECO LUCE CAN CAUSE DAMAGE TO PEOPLE, ANIMALS OR THINGS, AND WILL VOID ANY WARRANTY OR LIABILITY.
- SWITCH OFF THE ELECTRICITY BEFORE CONDUCTING ANY KIND OF MAINTENANCE.
- THE PRODUCT MUST BE INSTALLED IN ACCORDANCE WITH BEST PRACTICE.
- DAMAGED COMPONENTS MUST BE REPLACED WITH MARECOLUCE ORIGINAL SPARE PARTS.
- MAX. LAMP SIZE (IN MM):

10W D60 L110

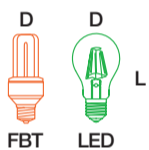

GENERAL MAINTENANCE RECOMMENDATIONS:

- CLEAN THE LUMINAIRE PERIODICALLY TO REMOVE POSSIBLE DIRT DEPOSITS THAT MAY DAMAGE IT OR ALTER THE PHOTOMETRICS PERFORMANCE.
- DO NOT USE HARSH DETERGENTS, ABRASIVE CLOTHES, HIGH-PRESSURE WASHERS, WATER AT A TEMPERATURE HIGHER THAN 60°C TO CLEAN THE LUMINAIRE.
- CHECK THE FIXING OF THE LUMINAIRE TO THE WALL/ACCESSORY.
- CHECK THE INTEGRITY OF THE FITTING COMPONENTS: REPLACE THEM IN CASE OF DAMAGE BY USING ONLY ORIGINAL MARECO LUCE PARTS
- CHECK THE PLASTIC CASINGS CAREFULLY IN ORDER TO IDENTIFY ANY POSSIBLE INSULATION DAMAGE.

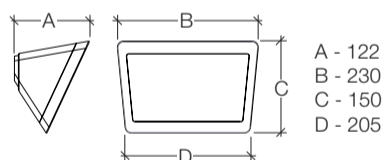
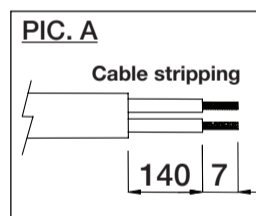

INSTALLATION INSTRUCTIONS WALL FIXING:

1. Unscrew the dowels (1) and remove the frame (2) and the diffuser (3).
2. Insert the wire guide grommet (4) in the appropriate seat on the body (5), paying attention not to damage it.
3. Unsheathe and strip the power cable as shown in Figure A, then insert the wires through the holes in the grommet (4);

ATTENTION: Use only flexible double sheath power cable (type HAR), the external diameter of the single unsheathed cable must be 3-4mm and the section of the internal wire section must be 1,5 - 2,5 sq. mm.

4. Connect the individual conductors to the lamp holder terminal (6), observing the correct polarities.
5. Secure the fitting to the wall using the screws and expansion plugs (not supplied);

ATTENTION: use screws and expansion plugs suitable for the type of installation.

6. Insert the caps (10) to protect the screws (9) to guarantee the declared IP degree.
7. Position the lamp holder (6) on the bottom of the base (7) and fix it using the screw (8) supplied
8. Insert the lamp (not supplied).
9. Position the diffuser (3), the frame (2) and fully tighten the dowels (1).

INSTALLATION INSTRUCTIONS WITH "GOLF" ACCESSORY (SINGLE POLE HEAD):

1. Unscrew the dowels (1) and remove the frame (2) and the diffuser (3).
2. Insert the wire guide grommet (4) in the appropriate seat on the body (5), paying attention not to damage it.
3. Insert the cable gland (11) into the hole in the pole top (12) and tighten the nut (13).
4. Insert the power supply cable (14) through the cable gland (11), unsheathe and strip the cable as in Figure A;

ATTENTION: Use only flexible double sheath power cable (type HAR), the external diameter of the cable must be 6-12mm. The external diameter of the single unsheathed cable must be 3-4mm and the section of the internal wire section must be 1,5 - 2,5 sq. mm.

5. Insert the conductors through the grommet (4), then connect them to the terminal of the lamp holder (6), observing correct polarities.
6. Secure the device to the pole top using the screws (15) and insert the caps (10) to protect the screws (15) to guarantee the declared IP protection degree.
7. Position the lamp holder (6) on the bottom of the base (7) and fix it using the screw (8) supplied
8. Insert the lamp (not supplied).
9. Position the diffuser (3), the frame (2) and fully tighten the dowels (1).
10. Firmly tighten the cable gland (11).
11. Secure the pole top (12) to the coupling by tightening the dowels (16).

INSTALLATION INSTRUCTIONS WITH "GOLF" ACCESSORY (DOUBLE POLE HEAD):

1. Unscrew the dowels (1) and remove the frame (2) and the diffuser (3).
2. Insert the wire guide grommet (4) in the appropriate seat on the body (5), paying attention not to damage it.
3. Introduce the power supply cables (17) through the holes (18), unsheathe and strip the cables as in Figure A;

ATTENTION: use only flexible power cable in double sheath with 4 poles (HAR type), the external diameter of the cable must be <12mm, the external diameter of the single unsheathed cable must be 3-4mm and the cross-section of the internal conductors must be 1,5 - 2,5 sq. mm.

4. Lock the power cables (17) in the cable clamps (19) by tightening the screws (20).
5. Insert the conductors through the grommet (4), then connect them to the terminal of the lamp holder (6), observing correct polarities.
6. Secure the devices to the pole top using the screws (15) and insert the caps (10) to protect the screws (15) to guarantee the declared IP protection degree.
7. Position the lamp holder (6) on the bottom of the base (7) and fix it using the screw (8) supplied
8. Insert the lamp (not supplied).
9. Position the diffuser (3), the frame (2) and fully tighten the dowels (1).
10. Secure the pole top (12) to the coupling by tightening the dowels (16).

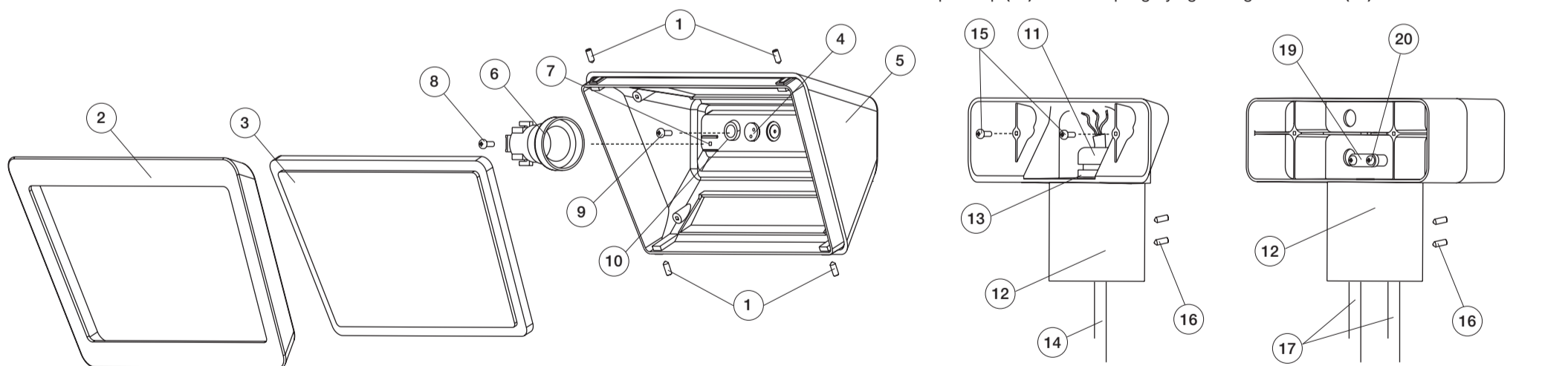

Golf - Pole-top adapter 1 light

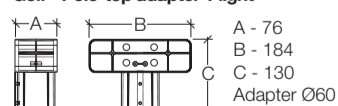

Golf - Pole-top adapter 2 lights

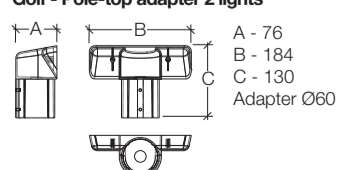

Installation on poles

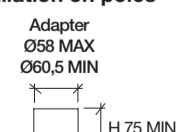

Measures expressed in mm

Installation on brackets

