

## Use and maintenance instructions

### Tetris

Fixed bollard for outdoor use, to be installed on concrete plinth

TECHNICAL DETAILS: refer to the product label



The UE declaration of conformity can be downloaded from our website [www.marecoluce.it](http://www.marecoluce.it)



Insulation Class II

**IP65**

Protection degree against dust ingress, solid particles, moisture



Caution, risk of electrical shock. The lighting source of this luminaire must be replaced by the Manufacturer only



This luminaire holds a lighting source in “E” energy efficiency class.

**SVM>0,9**

This product is intended for use in outdoor applications, industrial applications and other applications for which lighting standards allow a CRI <80.



This product must not be disposed as a normal household waste

### WARNINGS.

- THE SAFETY OF THIS PRODUCT IS GUARANTEED ONLY WITH THE RESPECT OF THE EXISTING RULES FOR THE ELECTRICAL SYSTEMS, AND WITH THE APPROPRIATE USE OF THESE INSTALLATION INSTRUCTIONS, THEREFORE IT IS NECESSARY TO KEEP THEM.
- THE IMPROPER USE OF THIS PRODUCT IS FORBIDDEN; ANY TAMPERING WITH THE PRODUCT OR MODIFICATION OF THE PRODUCT THAT IS NOT AUTHORIZED BY MARECO LUCE CAN CAUSE DAMAGE TO PEOPLE, ANIMALS OR THINGS, AND WILL VOID ANY WARRANTY OR LIABILITY.
- SWITCH OFF THE ELECTRICITY BEFORE CONDUCTING ANY KIND OF MAINTENANCE.
- THE PRODUCT MUST BE INSTALLED IN ACCORDANCE WITH BEST PRACTICE.
- THIS PRODUCT IS SUITABLE FOR OUTDOOR INSTALLATION ONLY.
- DAMAGED COMPONENTS MUST BE REPLACED BEFORE PUTTING THE PRODUCT BACK INTO SERVICE WITH MARECOLUCE SPARE PARTS.
- IT IS THE INSTALLER RESPONSIBILITY TO CHOOSE THE SUITABLE FIXING SURFACE TO SECURE THE FLANGE ON AND THE SUITABLE FIXING TOOLS.
- IT IS THE INSTALLER RESPONSIBILITY TO MAKE THE FIXING PLINTH OF THE SUITABLE DIMENSIONS.
- THE BASE AND THE OTHER PARTS OF THE PRODUCT CANNOT BE COVERED BY SOIL OR PUT IN CONTACT WITH AGGRESSIVE CHEMICAL SUBSTANCES (HERBICIDES, FERTILIZINGS, ETC).

### GENERAL MAINTENANCE RECOMMENDATIONS:

- CLEAN THE LUMINAIRE PERIODICALLY TO REMOVE POSSIBLE DIRT DEPOSITS THAT MAY DAMAGE IT OR ALTER THE PHOTOMETRICS PERFORMANCE.
- DO NOT USE HARSH DETERGENTS, ABRASIVE CLOTHES, HIGH- PRESSURE WASHERS, WATER AT A TEMPERATURE HIGHER THAN 60°C TO CLEAN THE LUMINAIRE.
- CHECK THE TIGHTENING OF THE SCREWS THAT FIX THE BASE TO THE PLINTH.
- CHECK THE INTEGRITY OF THE FITTING COMPONTS: REPLACE THEM IN CASE OF DAMAGE BY USING ONLY ORIGINAL MARECO LUCE PARTS.

**Pict. 1**

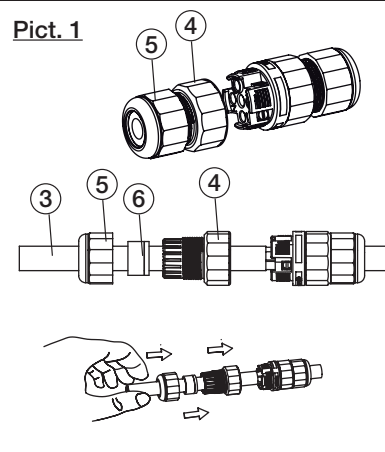

**Pict. 2**

Guide for the correct cable polarity

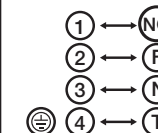

If necessary, control the hearth connection indications on the product label

Cable stripping

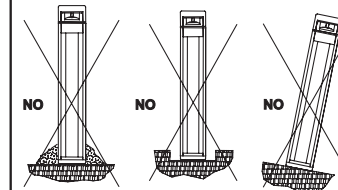
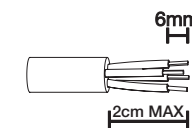

### INSTALLATION INSTRUCTIONS:

1. Unscrew the screws (1) and remove the flange (2).
2. Insert the power supply cable (3) into the hole of the flange (2).
3. Secure the flange (2) to the mounting surface by using the anchor-bolts kit (optional), or some screws and expansion plugs (not included).

**CAUTION:** Choose screws and expansion caps suitable for the type of installation that you are conducting.

4. Untighten the ferrule (4) of the tinned terminal block (see Pict. 1 and 2).
5. Insert the power supply cable (3) in the ferrule (4). If needed: untighten the ferrule (5) and insert the power supply cable (3) into the gasket (6) and then in the ferrule (4). (See Pict.1).
6. Close the terminal block by tightening the ferrule (4) first, and then the other ferrule (5) to make a watertight connection and ensure the declared IP rate.

**CAUTION:** use only a flexible double insulation sheath (type HAR) or one suitable for outdoor use. The outer cable diameter must range between 7 and 12mm. If a cable with diameter higher than 9mm is used, remove the inner gasket (6). The thickness of the inner electrical wires must range between 0,5 and 1,5 mmq.

7. Position the luminaire (7) on the flange (2) and tighten the screws (1) fully.

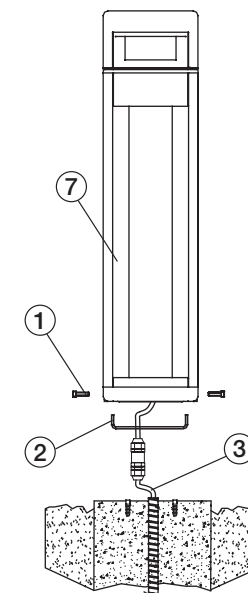

**Tetris 1**

A200  
B600/1000  
Fixing holes Ø8.5mm

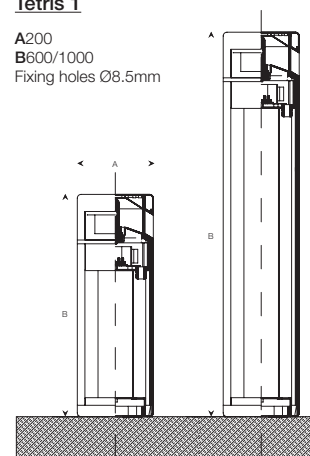

**Tetris 2**

A200  
B280/600/1000  
Fixing holes Ø8.5mm

