

INSTALLATION INSTRUCTIONS:

1. Remove the diffuser (1) by turning it anti-clockwise of about 30°.

2. **LED's VERSION:** Insert the supply cable into the grommet, and connect the cables to the terminal paying attention to respect the polarities and the insulation class of the luminaire.

WARNING: If you use a flexible HAR-type supply cable with double sheath, the outside diameter of the cable must not exceed 8mm and the section of the internal cables must be between 0.5 and 1.5 mmq.

LED's VERSION WITH MOTION SENSOR: Insert the supply cable into the grommet, and connect the cables to the terminal block of the motion sensor, paying attention to respect the polarities and the insulation class of the luminaire.

WARNING: If you use a flexible HAR-type supply cable with double sheath, the outside diameter of the cable must not exceed 8mm and the section of the internal cables must be between 0.5 and 0.75 mmq.

Program the motions sensor by selecting the desired parameters through the appropriate switches (see the instructions for programming the motion sensor).

3. Secure the base (2) to the wall/ceiling by using some screws or expansion caps (not included).

4. Position the diffuser (1) on the base (2) and turn it clockwise until it stops.

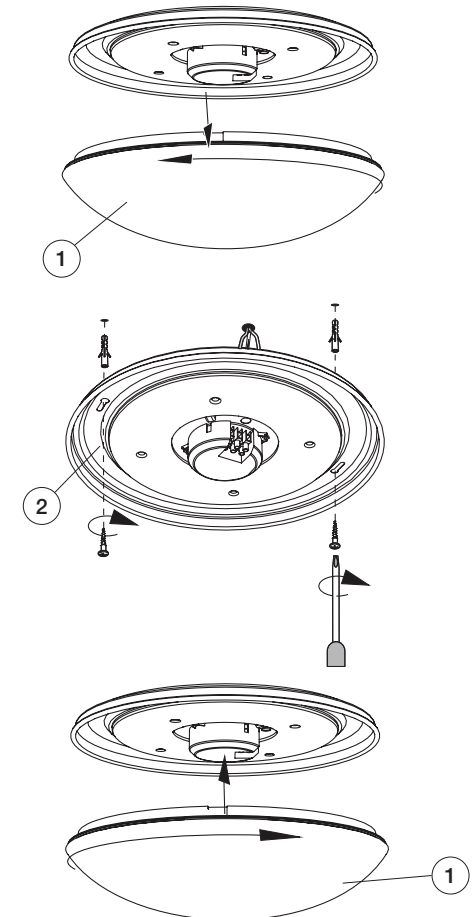
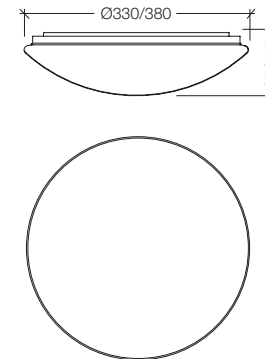

Use and maintenance instructions

Dorado led/Dorado led with motion sensor

Outdoor luminaire suitable for installation on wall or ceiling

TECHNICAL DETAILS: refer to the product label

 The UE declaration of conformity can be downloaded from our website www.marecoluce.it

IP20 Protection degree against dust ingress, solid particles, moisture

 Caution, risk of electrical shock

 This product must not be disposed as a normal household waste

WARNINGS:

- THE SAFETY OF THIS PRODUCT IS GUARANTEED ONLY WITH THE RESPECT OF THE EXISTING RULES FOR THE ELECTRICAL SYSTEMS, AND WITH THE APPROPRIATE USE OF THESE INSTALLATION INSTRUCTIONS, THEREFORE IT IS NECESSARY TO KEEP THEM.
- THE IMPROPER USE OF THIS PRODUCT IS FORBIDDEN; ANY TAMPERING WITH THE PRODUCT OR MODIFICATION OF THE PRODUCT THAT IS NOT AUTHORIZED BY MARECO LUCE CAN CAUSE DAMAGE TO PEOPLE, ANIMALS OR THINGS, AND WILL VOID ANY WARRANTY OR LIABILITY.
- SWITCH OFF THE ELECTRICITY BEFORE CONDUCTING ANY KIND OF MAINTENANCE.
- THE PRODUCT MUST BE INSTALLED IN ACCORDANCE WITH BEST PRACTICE.
- THE LIGHT SOURCE OF THIS PRODUCT IS NOT REPLACEABLE, THEREFORE, WHEN IT REACHES THE END OF LIFE THE WHOLE LUMINAIRE MUST BE REPLACED.
- IN CASE OF DAMAGED COMPONENTS, THEY MUST BE REPLACED WITH SPARE PARTS SUPPLIED BY MARECO LUCE BEFORE SWITCHING ON THE LUMINAIRE.

GENERAL MAINTENANCE RECOMMENDATIONS:

- CLEAN THE LUMINAIRE PERIODICALLY IN ORDER TO REMOVE DIRT DEPOSITS ON THE DIFFUSER.
- DO NOT USE HARSH DETERGENTS TO CLEAN THE DIFFUSER.
- CHECK THE TIGHTNESS OF THE SCREWS SECURING THE LUMINAIRE TO THE SURFACE OF INSTALLATION.
- CHECK THE INTEGRITY OF THE FITTING COMPONENTS: REPLACE THEM IN CASE OF DAMAGE BY USING ONLY ORIGINAL MARECO LUCE PARTS.