



## Use and maintenance instructions

### ZAP

Outdoor luminaire suitable for installation on poles or brackets Ø60mm on top

TECHNICAL DETAILS: refer to the product label

 The UE declaration of conformity can be downloaded from our website [www.marecoluce.it](http://www.marecoluce.it)

 Insulation Class II

**IP55** Protection degree against dust ingress, solid particles, moisture

 This product must not be disposed as a normal household waste

### AVVERTENZE:

- THE SAFETY OF THIS PRODUCT IS GUARANTEED ONLY WITH THE RESPECT OF THE EXISTING RULES FOR THE ELECTRICAL SYSTEMS, AND WITH THE APPROPRIATE USE OF THESE INSTALLATION INSTRUCTIONS, THEREFORE IT IS NECESSARY TO KEEP THEM
- THE IMPROPER USE OF THIS PRODUCT IS FORBIDDEN; ANY TAMPERING WITH THE PRODUCT OR MODIFICATION OF THE PRODUCT THAT IS NOT AUTHORIZED BY MARECO LUCE CAN CAUSE DAMAGE TO PEOPLE, ANIMALS OR THINGS, AND WILL VOID ANY WARRANTY OR LIABILITY.
- SWITCH OFF THE ELECTRICITY BEFORE CONDUCTING ANY KIND OF MAINTENANCE.
- THE PRODUCT MUST BE INSTALLED IN ACCORDANCE WITH BEST PRACTICE
- DAMAGED COMPONENTS MUST BE REPLACED WITH MARECOLUCE ORIGINAL SPARE PARTS
- DO NOT PLACE ANY OBJECT ON THE DIFFUSER AND DO NOT COVER IT.
- MAX. LAMP SIZE (IN MM):  
- 23W D80 L170

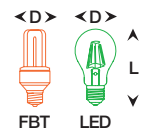

### GENERAL MAINTENANCE RECOMMENDATIONS:

- CLEAN THE FITTING PERIODICALLY TO REMOVE POSSIBLE DIRT/GROUND DEPOSITS ON THE DIFFUSER.
- CHECK THAT THE FITTING IS CORRECTLY FIXED TO THE POLE TOP BY REFERRING TO THE INSTALLATION INSTRUCTIONS.
- DO NOT USE HARSH DETERGENTS TO CLEAN THE DIFFUSER.
- CHECK THE INTEGRITY OF THE FITTING COMPONENTS: REPLACE THEM IN CASE OF DAMAGE BY USING ONLY ORIGINAL MARECO LUCE PARTS.
- CHECK THE PLASTIC CASINGS CAREFULLY IN ORDER TO IDENTIFY ANY POSSIBLE INSULATION DAMAGE.

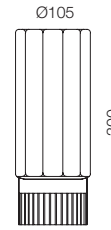

### Installation on brackets

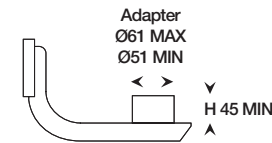

### Installation on poles

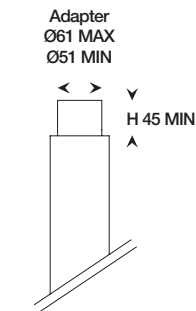

Sizes in mm

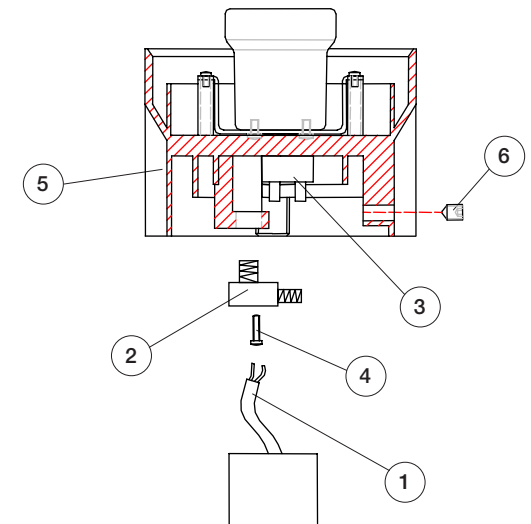
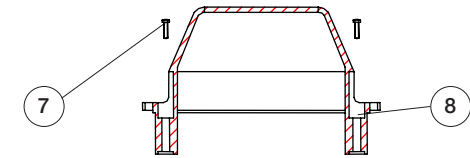

### INSTRUCTIONS FOR POLE-MOUNTING:

1. Insert the supply cable (1) into the cord block (2). Connect the supply cables to the terminal block (2) and tighten the screw of the cord block.

**CAUTION:** use only a flexible double insulation sheath (type HAR). The outer cable diameter must be lower than 6,5 mm and the thickness of the inner electrical wires must range between 0,5 and 2.5mmq

2. Insert the base (5) into the pole and tighten the dowel strongly (6).
3. Insert the lamp (not included).
4. Insert the diffuser and turn it clockwise until it stops.